

RAD I.  $\phi$  110 x 10

H5

0.9

0.8

H4

0.78010

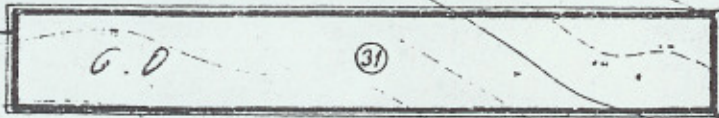

0.101619

RAD VI.  $\phi$  110 x 10

RAD V.  $\phi$  110 x 10

0.11900

H15

28



0.70400  
0.7

RAD I.  $\phi$

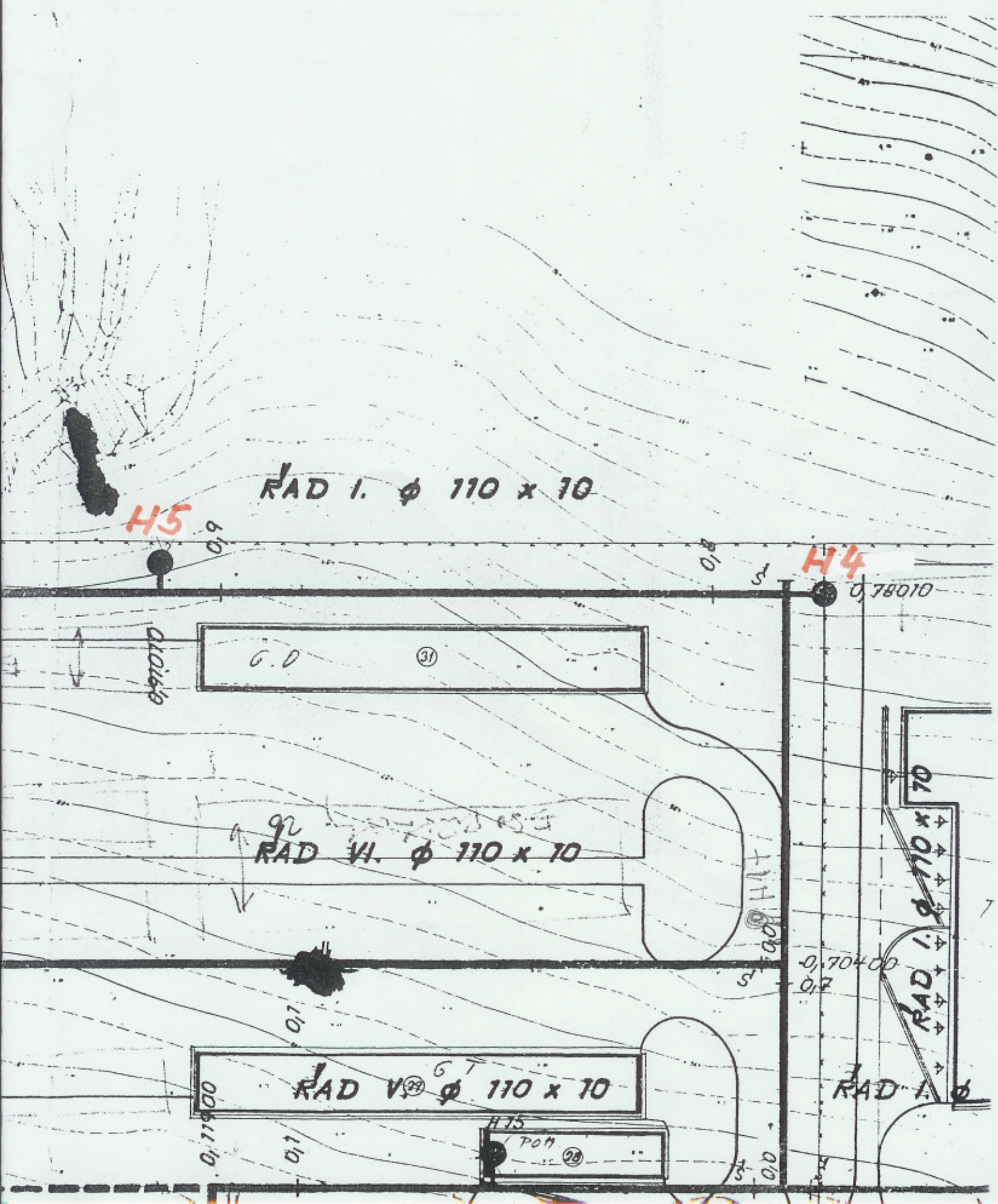

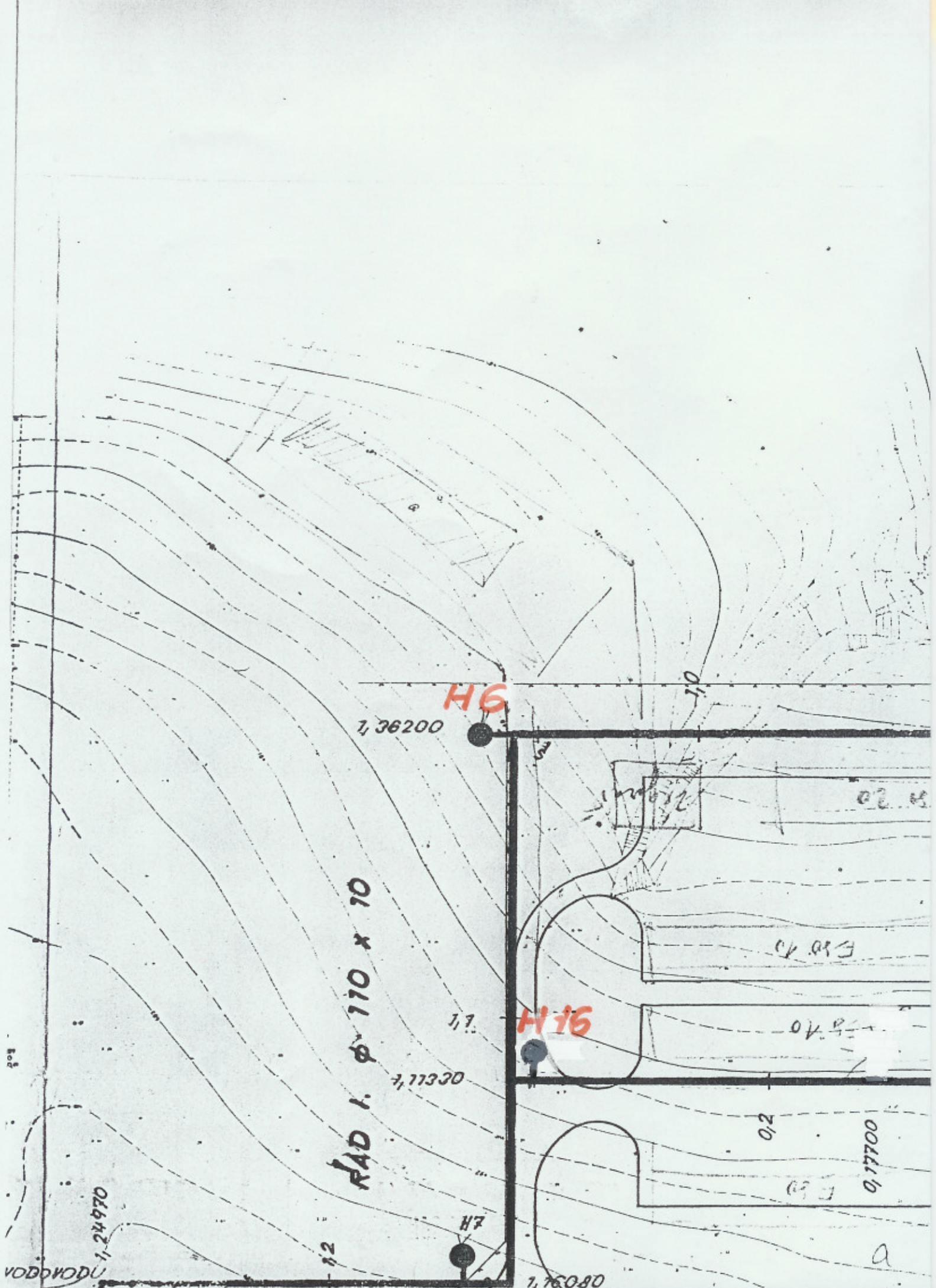

H6

1,36200

RAD I. Ø 110 x 10

H16

1,77300

H7

1,76080

VODOVODU 1,24970

0,17700

a

